



US Army Corps
of Engineers®
Fort Worth District

Canyon Lake Potters Creek Park

← To FM 306
Potters Creek Rd

Potters Creek Rd

Causeway Rd

Park Gates Lock at 10 pm. You may leave but cannot re-enter until 8am.

Ramp 21
24-hour Access

Reservations Only
Check Out 10am

Ramp 20

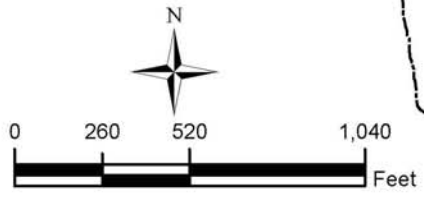
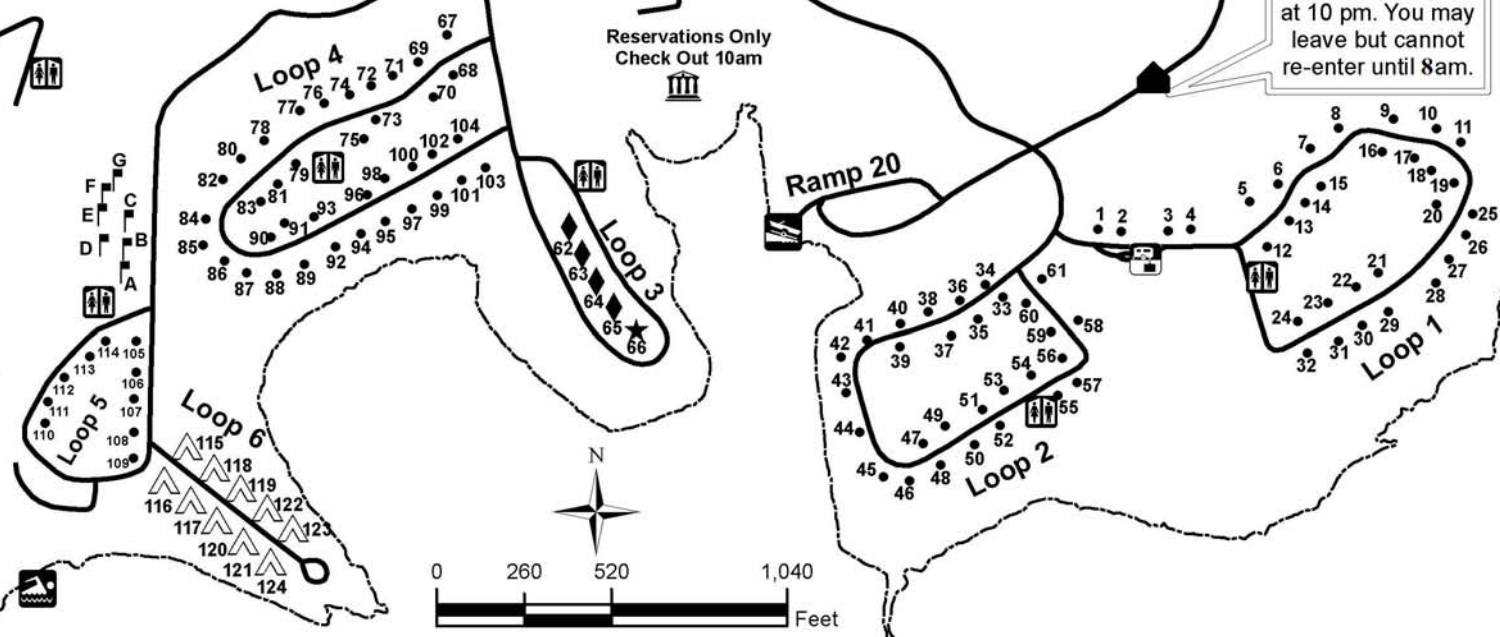

Site Details	Tent Only	Single RV/Tent	Double RV/Tent	Triple RV/Tent	Screen Shelter	Group Shelter
# Sites	10	109	1	4	7	1
Site Cost	\$20	\$26	\$40	\$60	\$40	\$100
Max Occupancy	10	10	20	30	10	50-100
Check In Time	3:00 PM	3:00 PM	3:00 PM	3:00 PM	3:00 PM	12:00 PM
Check Out Time	2:00 PM	2:00 PM	2:00 PM	2:00 PM	2:00 PM	10:00 AM

Legend

- RV Site
- ⌂ Screened Shelter
- ⚙ Tent Camping
- ★ Family - Double Site
- ◆ Family - Triple Site
- ⛪ Group Shelter
- 🏠 Gate House
- 🗑 Dump Station
- 🚻 Restroom
- 🐟 Fishing Pier
- 🏊 Swim Beach
- 🚤 Boat Ramp
- ⬜ pklimits
- Roads

*Amenities at each site: Water, Electricity, Fire Ring, Covered Picnic Table, Standing Closable Grill.

Public use of facilities, land and water surfaces of Canyon Lake is governed by State and Federal laws and regulations. Title 36, Code of Federal Regulations, Part 327, sets forth expected standards of park use. A list of the most often violated provisions of Title 36 is listed below. This is not a complete list of regulations. Even if a section of Title 36 is not listed below, it still applies.

Title 36, Code of Federal Regulations, Part 327,

1. Camping is limited to 14 days in a 30-day period. (36 CFR 327.7b)
2. **Vehicles with visitor passes must leave the park by 10 pm closing time.** (36 CFR 327.12a)
3. **Quiet hours are from 10 pm to 6 am.** These will be enforced. (36 CFR 327.12b)
4. Radios or car stereos must be kept at a sound level that will not disturb other campers and visitors. (36 CFR 327.12b)
5. **Fireworks or loaded firearms are prohibited.** (36 CFR 327.13)
6. **DO NOT MAKE ROCK FIRE RINGS.** Rock fire rings or ground fires are prohibited. Fires must be confined to stand up grills or metal fire rings provided for that purpose. (36 CFR 327.10b)
7. **Cutting or breaking of trees or tree limbs is prohibited.** Gathering of dead wood on the ground is permitted, provided that the wood is used in the park. (36 CFR 327.14b,c)
8. All vehicles must be parked in designated park spaces and not on the road or the grass. No vehicle is to be used or parked off road. It is prohibited. (36 CFR 327.2)
9. Swimming is at your own risk. (36 CFR 327.5a)
10. **Swimming, sun bathing, or fishing on or around boat ramps or docks is prohibited.** (36 CFR 327.5a)
11. **Pets must be kept on a leash not longer than six feet in length, at all times.** (36 CFR 327.11)
12. No pets allowed on beaches. (36 CFR 327.11)
13. Pets may not be left unattended. (36 CFR 327.11)
14. **Persons shall be responsible for proper removal and disposal of any waste produced by animals.** (36 CFR 327.11)
15. Keep campsites and park grounds free of litter; **deposit trash in receptacles provided.** (36 CFR 327.9)

16. Vehicle washing of any kind is not permitted on camp grounds. (36 CFR 327.9)
17. **Visitors must obey all posted signs and restrictions.** (36 CFR 327.12)

*****FOR EMERGENCIES DIAL 911*****

Campsite Rules

- **CAMPING ONLY! NO DAY USE!**
- No one allowed in park to walk, jog, hike or bike, unless you are a paying guest renting a site.
- Park Open All Year.
- Park gates open daily at 8 am and close at 10 pm.
- Screen Shelters, RV or Tent Sites:
 - Check-In 3 pm, Check-Out 2 pm
- Group Shelter Only
 - Check-In 12 pm, Check-Out 10 am
- Campsite rentals limited to one per adult customer. Individuals may not rent sites for friends or relatives arriving later.
- Maximum of 10 persons per single-use campsite. This includes all visitors.
- Maximum of two camping units per single-use campsite. Examples: (1 RV + 1 Tent) or (1 Trailer + 1 Tent) or (2 Tents).
- Maximum of 2 vehicles or 1 boat & 1 vehicle per single-use campsite for overnight occupancy (does not include RV).
- Maximum 2 extra vehicles per single-use campsite between 7 am – 10 pm.
- **1 boat or jet-ski trailer per site limit.**
- **NO 2nd boat or jet-ski trailer allowed.**
- Vehicle = anything that requires a parking space.
- Drive-Thru Policy:
 - 10 Minutes Free
 - Daylight Hours Only (Mon-Thurs)
 - Restrictions: Fri-Sun, Holidays & during Peek Occupancy

U.S. Army Corps of Engineers
Canyon Lake Office
601 C.O.E. Road
Canyon Lake, TX
(830) 964 – 3341

<http://www.swf-wc.usace.army.mil/canyon/>

Potters Creek Park

A Camping & RV Park
At Canyon Lake

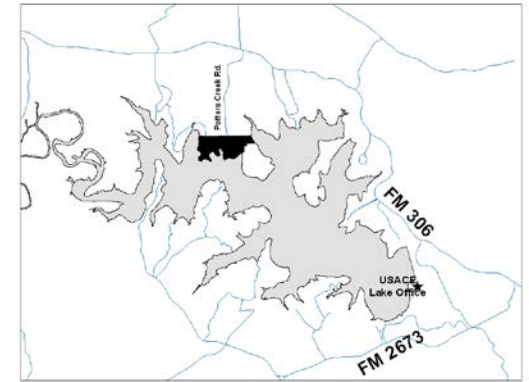

Please Have A Safe And Enjoyable Visit

Life Jackets Save Lives.
It Floats, You Don't!
Wear Your Life Jacket!



**US Army Corps
of Engineers** ®
Fort Worth District

Last update: May 2014